

The Information contained in this document is the property of Cooper Industries, Inc. It is not for public disclosure. Possession of the Information does not convey any right to loan, sell, or disclose the Information. Unauthorized reproduction or use of the Information is Prohibited. This document is to be returned to Cooper Industries, Inc. upon completion of the purpose for which it is loaned or upon request.

This is an unpublished work. The disclosure of this work is limited to a select personnel. Further dissemination or disclosure to the public is PROHIBITED. This unpublished work is protected by Federal Copyright Law and all rights thereunder are reserved by Cooper Industries, Inc.

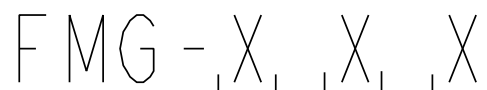

```

0 = NO COVER
1 = COVER (BLACK) INSTALLED
2 = COVER (BLACK) SHIPPED BULK
3 = RESERVED ---> SEE FMG - 333
4 = COVER (RED) INSTALLED
5 = COVER (RED) SHIPPED IN BULK
6 = EXTENDED COVER (BLACK) INSTALLED
7 = EXTENDED COVER (BLACK) SHIPPED IN BULK
8 = EXTENDED COVER (RED) INSTALLED
9 = EXTENDED COVER (RED) SHIPPED IN BULK

```

0 = NO NUTS  
1 = NUTS INSTALLED  
2 = NUTS SHIPPED BULK  
3 = STAINLESS NUTS & LOCKWASHERS INSTALLED  
4 = STAINLESS NUTS & LOCKWASHERS SHIPPED BULK

1 = BASE WITH M8x1.25 METRIC STUDS  
2 = BASE WITH 5/16-18 UNC STUDS  
3 = BASE WITH M8x1.25 STAINLESS STUDS  
4 = BASE WITH 5/16-18 UNC STAINLESS STUDS

TORQUE RATING: 10 FT-LBS

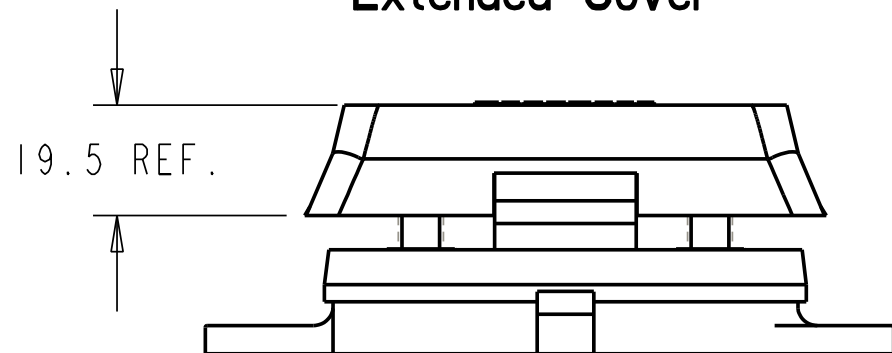

## Standard Cover

—	0.13
---	------



**COOPER Bussmann**  
St. Louis, MO

METRIC (mm)	ENGLISH (in)
PL DEC.: ± .25	2 PL DEC.: ± .01
PL DEC.: ± .13	3 PL DEC.: ± .005

A technical drawing of a tapered shaft. The left part is a perspective view of a truncated cone (tapered shaft) with a horizontal centerline. The right part is a circular end view showing concentric circles and a crosshair indicating the center.

ANGULAR TOL:  $\pm 2^{\circ}$   
FRACTION TOL:  $\pm 1/64$  IN

Plant Code:	J,56
Design Units	
Metric	

For change history please  
consult the Busmann  
Engineering Change  
Notice number listed below.

**BU-U07180**

Title:  
**FMG Fuse Holder**

Sheet 1 of 1	Scale: 0.750	Revision.Version 7.1
--------------	--------------	----------------------

Date: 01-May-02	Created By: K. Moore
-----------------	----------------------

Part Number: **FMG-XXX-SALES**

Ref. Name: FMG-XXX-SALES