

## AMI 80A Midi Fuse 80A-80V

AMI080



Advance the security of your electrical system with Alvolta's AMI/ Midi fuses, designed specifically to offer overcurrent protection. Crafted from premium tin-plated copper terminals with a PA66+30GF (Polyamide/Nylon 66 with Glass Fibre Reinforcement) unit, these fuses are ideal for ensuring optimal circuit performance while preventing any short circuits and overloads in your 32V system. AMI/ Midi fuses offer a cost-effective, space-saving fuse option that is designed for high-current applications. Each fuse is designed to have a small footprint with a bolt-down design, making the fuses a standard circuit protection choice for automobiles and trucks. AMI/ Midi fuses are ideal for battery and alternator connections and other medium gauge cables requiring high current protection.

### Product Dimensions

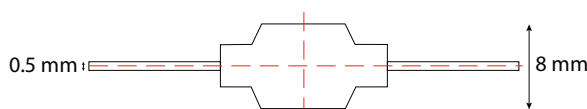
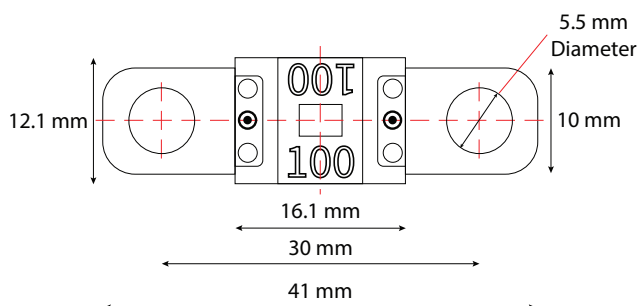

### Product Properties

Voltage Rating	DC 58V or Less
Interrupting Rating	2000A at 58V DC
Operating Temperature	-40°C to +125°C
Typical Voltage Drop	110 mV
Mounting Torque	4.3-4.6 N.m
Housing Material	PA66+30GF (UL94-V0)
Terminal	Copper Alloy
Colour	Silver
Compliance	ISO 8820-5 / GB/T31465.5

### Time-Current Characteristics

Test Current	Opening Time			
	30A~125A		150A~200A	
	Min.		Max.	
75%	-	-	100 hrs	-
100%	100 hrs	-	-	-
110%	4 hrs	-	-	-
150%	90 s	3600 s	-	-
200%	3 s	100 s	1 s	15 s
300%	0.3 s	3 s	-	-
350%	-	-	0.3 s	5 s
500%	0.1 s	1 s	-	-
600%	-	-	0.1 s	1 s

### Suitable for:

